

# Specification Datasheet

Viamed

SpiroTrue PED

OEM Disposable Single Patient Paediatric Flow Sensor

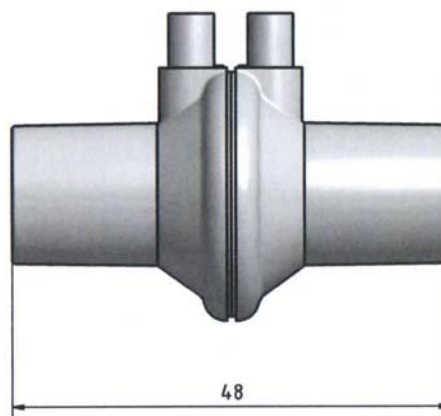
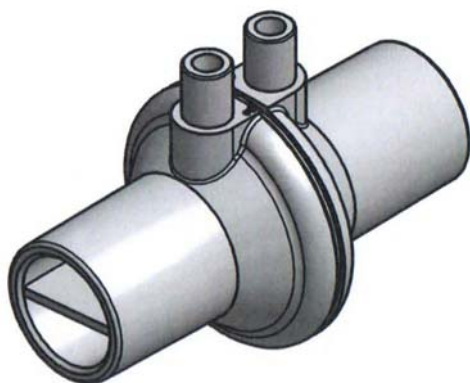

CE

<b>Part number</b>	4310070 OEM pack of 6
<b>Model</b>	SpiroTrue PED – OEM disposable single patient paediatric flow sensor
<b>Primary packaging</b>	PE pouch (bag) with 6 sets

## Technical Data

<b>Measuring principle</b>	Differential pressure measurement
<b>Reproducibility</b>	≤ 10% at flow range 0 to 60l/min
<b>Designed in accordance with</b>	93/42/EEC (Annex I and Annex II)
<b>Housing material</b>	ABS (Acrylnitril-Butadien-Styrol)
<b>Weight</b>	≤ 6.5g (without tubing)
<b>Dead space</b>	≤ 7ml
<b>Connectors</b>	15mm O.D./15mm O.D. in accordance with DIN EN ISO 5356-1
<b>Conforms with</b>	EN ISO 10993-5
<b>Components including tubing conform with</b>	2011/65/EC (RoHS)
<b>Packaging</b>	Non-sterile
<b>Storage temperature</b>	-20°C to 50°C
<b>Humidity (R.H.)</b>	5% to 95%
<b>Storage period</b>	≤ 3 years (unopened, away from direct sunlight)
<b>Operating temperature</b>	10°C to 40°C
<b>Relative humidity</b>	≤ 95%, non-condensing
<b>Warranty period</b>	??12 months from date of sales invoice

**Notes:** Before using the sensor consult the appropriate ventilator user instructions for more detailed information  
 Sensor was tested on OxyLog 3000 SW1.21  
 Setup: 190 Dräger circuit REF 5704964-10; 2.0l Dräger test lung with restrictor 7mm: REF 2165694

SpiroTrue PED with double PVC (DEHP free) tube is available upon request