

Specification Datasheet

Viamed

SpiroTrue PED

OEM Disposable Single Patient Paediatric Flow Sensor

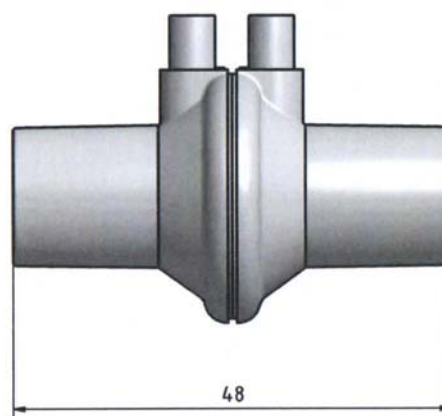
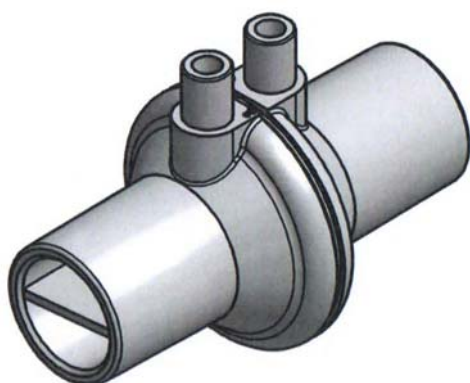

CE

Part number	4310070 OEM pack of 6
Model	SpiroTrue PED – OEM disposable single patient adult flow sensor
Primary packaging	PE pouch (bag) with 6 pieces or 6 sets

Technical Data

Measuring principle	Differential pressure measurement
Reproducibility	≤ 10% at flow range 0 to 60l/min
Designed in accordance with	93/42/EEC (Annex I and Annex II)
Housing material	ABS (Acrylnitril-Butadien-Styrol)
Weight	≤ 6.5g (without tubing)
Dead space	≤ 7ml
Connectors	15mm O.D./15mm O.D. in accordance with DIN EN ISO 5356-1
Conforms with	EN ISO 10993-5
Components including tubing conform with	2011/65/EC (RoHS)
Packaging	Non-sterile
Storage temperature	-20°C to 50°C
Humidity (R.H.)	5% to 95%
Storage period	≤ 3 years (unopened, away from direct sunlight)
Operating temperature	10°C to 40°C
Relative humidity	≤ 95%, non-condensing
Warranty period	??12 months from date of sales invoice

Notes: Before using the sensor consult the appropriate ventilator user instructions for more detailed information
 Sensor was tested on OxyLog 3000 SW1.21
 Setup: 190 Dräger circuit REF 5704964-10; 2.0l Dräger test lung with restrictor 7mm: REF 2165694

SpiroTrue PED with double PVC (DEHP free) tube is available upon request