

Specification Datasheet

Viamed

SpiroTrue PED

OEM Disposable Single Patient Paediatric Flow Sensor

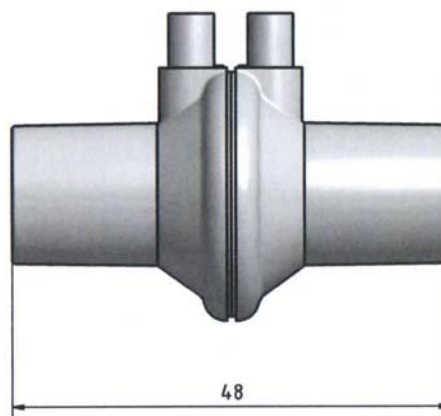
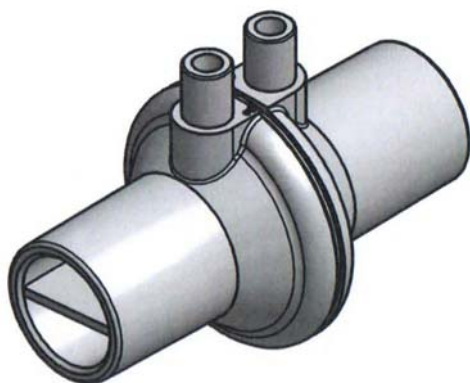

CE

Part numbers	4310070 OEM pack of 6
Model	SpiroTrue D – OEM disposable single patient adult flow sensor
Primary packaging	PE pouch (bag) with 6 pieces or 6 sets
Secondary packaging	???Box of 10 bags x 20pcs/sets each. 200pcs/200 sets total per box

Technical Data

Sensor measuring principle	Differential pressure measurement
Sensor reproducibility	≤ 10% at flow range 0 to 60l/min
Sensor housing material	ABS (Acrylnitril-Butadien-Styrol)
Sensor weight	≤ 6.5g (without tubing)
Sensor dead space	≤ 7ml
Sensor connectors	15m/15m in accordance with DIN EN ISO 5356-1
Recommended storage temperature	-20°C to 50°C
Humidity (R.H.)	5% to 95%
Recommended period of storage	≤ 3 years (unopened packaging and kept away from sunlight)
Recommended operating temperature	10°C to 40°C
Relative humidity	≤ 95%, non-condensing
Warranty period	??12 months from date of sales invoice

Sensor is in non-sterile packaging
 Sensor designed in accordance with 93/42/EEC (Annex I and Annex II)
 Sensor conforms to EN ISO 10993-5
 Sensor components including sensor tubing conforms to 2011/65/EC (RoHS)

Please note: Before using the sensor consult the appropriate ventilator user instructions for information regarding the risks related to the use of this product.

Sensor was tested on OxyLog 3000 SW1.21

Setup: 190 Dräger circuit reg 5704964-10; 2.0l Dräger test lung with restrictor 7mm: ref 2165694

SpiroTrue PED with double PVC (DEHP free) tube is available upon request