

Department Manager

«DEPARTMENT»

«COMPANY»

«ADDRESS1»

«ADDRESS2»

«ADDRESS3»

«CITY» «STATE»



«ZIP»

January 2022

Dear Sir or Madam,

### Viamed: The Leading Medical Oxygen Sensor Supplier

The **extended** range of Medical Oxygen Sensors from Viamed provides the **widest range** and the **latest technology** to allow you to get the best value for money when using OEM and compatible oxygen sensors. The range includes original Viamed Oxygen Sensors, including the R-23V which is compatible with the Dräger 6850645, Maxtec MAX-11 and Analytical Industries PSR-11-915-2 oxygen sensors and the R-23Vi which is for use with the I8000 incubators.

0110023 R-23V	0110025 R-23Vi
	
<b>Main OEM:</b> Dräger <b>OEM Sensor Part No.:</b> 6850645 <b>Output Connector:</b> Slip rings, 3 <b>Sensor Output:</b> 24 - 32 $\mu$ A <b>Sensor Life:</b> $\geq$ 500,000 % oxygen hours <b>Response Time:</b> < 12 seconds <b>Warranty:</b> 15 months	<b>Main OEM:</b> Dräger <b>Application:</b> I8000 incubator <b>Output Connector:</b> Slip rings, 3 <b>Sensor Output:</b> 24 - 32 $\mu$ A <b>Sensor Life:</b> $\geq$ 750,000 % oxygen hours <b>Response Time:</b> < 12 seconds <b>Warranty:</b> 15 months

from  
**£36**

Viamed continues to provide an oxygen sensor **quantity discount pricing** structure, there is **no minimum order value**, **free of charge delivery** and the **NHS credit facility** is offered on our **entire** range of oxygen sensors. I am sure you will find that this makes ordering easier and provides an extremely competitive package on quality, price, delivery and support.

### [SpiroTrue A, A\(PC\) and H](#)

[For flow measurement of gas delivered by anaesthesia systems and ventilators](#)

### [SpiroTrue A and A\(PC\) Hot-wire flow sensor for use with Dräger ventilators](#)

In 2009 Viamed introduced the 4310001 SpiroTrue A flow sensor, which is compatible to the Dräger Spirolog® flow sensor part no. 84 03 735. The sensor can be disinfected and in practice used either on single or multiple patients - depending upon the application and in accordance with local guidelines.

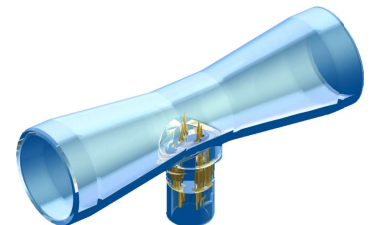

As clinical practices do vary - we have developed an autoclavable version of the sensor, in order to meet with market requests. In turn this allows users to abide by differing local protocols and guidelines, and to also meet with all interpretations of current and future regulations.

This variant, the SpiroTrue A(PC) is compatible to the standard version, but is manufactured from strong Polycarbonate material as opposed to ABS plastic. The SpiroTrue A(PC), which is compatible to the Dräger SpiroLife® flow sensor part no. MK 01900, is also available at the same competitive price.

**ST-BLR and ST-BL Neonatal Flowsensors COMING SOON**  
**For flow measurement of respiratory gas flow delivered in Dräger neonatal ventilators**

The ST-BLR flow sensor is a reusable cost-effective neonatal hot wire anemometric flow sensor with insert, for measuring gas flow in Dräger neonatal ventilators.

Each ST-BLR flow sensor comes with a reusable outer housing and an installed reusable insert. Additional inserts can be purchased.

The ST-BLR flow sensor is a direct compatible to the Dräger neonatal flow sensor ISO 15, REF 8411130 and the ST-BLR INSERT is a direct compatible to the Dräger neonatal flow sensor INSERT, REF 8410179.

Also available, the disposable ST-BL flow sensor comprising of an outer housing with integrated insert.

<b>4310004</b>	ST-BLR Neonatal Flow Sensor with reusable housing and insert
<b>4310005</b>	ST-BLR-INSERT Insert for ST-BLR Neonatal Flow Sensor (Box of 5)
<b>4310006</b>	ST-BL Disposable Neonatal Flow Sensor with fixed insert

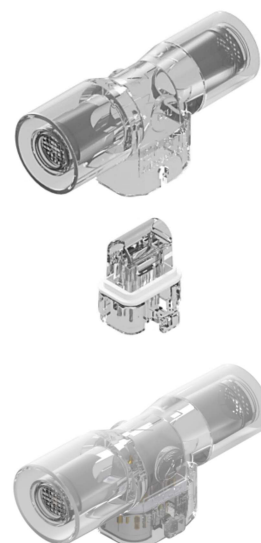

Please find enclosed the R-23V/Vi and Flowsensors leaflet which I hope you find of interest.

Should you require further information on applications and compatibility, please visit our website – **[www.viamed.co.uk](http://www.viamed.co.uk)** or go straight to our oxygen sensor cross reference **[www.viamed.co.uk/xref](http://www.viamed.co.uk/xref)** or our Flowsensor cross reference **[www.viamed.co.uk/flowsensors-xref](http://www.viamed.co.uk/flowsensors-xref)**

Should you wish to place an order, or cannot find your oxygen sensor or equipment listed on the online cross reference, then please contact a member of our sales team on **01535 634542** or email **[info@viamed.co.uk](mailto:info@viamed.co.uk)**

Yours faithfully

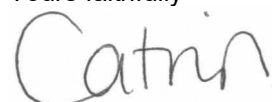

Catrin Hollings  
Marketing

Should you wish to unsubscribe from our mailings please email **[unsubscribe@viamed.co.uk](mailto:unsubscribe@viamed.co.uk)**