

# product portfolio



VIAMED



## Contact Us



**+44 (0)1535 634 542**



**+44 (0)1535 635 582**



**+44 (0)1535 636 757**



**15 Station Road  
Cross Hills  
Keighley  
West Yorkshire  
BD20 7DT  
United Kingdom**



**info@viamed.co.uk**



**www.viamed.co.uk**

oxygen sensors & flowsensors 4

oxygen monitoring 6

capnography 7

pulse oximetry 9

blenders 12

patient warming 14

phototherapy 15

posey neonatal & paediatric products 16

test equipment 17

temperature probes 18

breathalyzers 19

## Oxygen Sensors

OEM and compatible oxygen sensors for use with most oxygen monitors, oxygen analysers, incubators, ventilators, oxygen concentrators, anaesthesia systems...



## Flow Sensors

For flow measurement of gas delivered by anaesthesia systems and ventilators

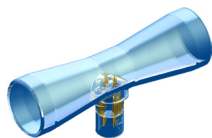

SpiroTrue A  
SpiroTrue A<sub>(PC)</sub>

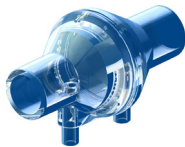

SpiroTrue H

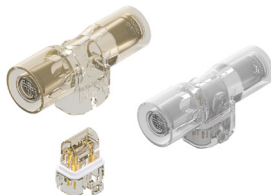

ST-BLR ST-BL  
Neonatal flow sensors  
coming soon

## Lead-free Oxygen Sensors



## RoHS COMPLIANT



The Restriction of the Use of Certain Hazardous Substances (RoHS) in Electrical and Electronic Equipment (EEE) Directive (2011/65/EU) 8th June 2011 was transposed into UK law on the 2nd January 2013. Under the recast RoHS, lead anodes in electrochemical oxygen sensors had been granted exemption status until 22nd July 2021.

However, the European Commission received two exemption requests during the period November-January 2019/2020. Therefore, whilst the review process is carried out, the exemption status has in effect been extended, until the Commission's decision is finalised.

In the meantime, Viamed continues to introduce and phase in a range of RoHS Compliant lead-free alternatives. Should you be unable to find the lead-free alternative you require, please contact us or visit our website [www.viamed.co.uk/xref](http://www.viamed.co.uk/xref)

## Oxygen Analysers and Monitors



Honeywell

## Sampling Line Solutions

### Gas Sampling Lines Type S



Including Luer Lock connections. These sampling lines do not remove humidity, but are economical, flexible and **do not kink**. Their multi-layer construction (PE/EVA/PVC) makes them suitable for use with anaesthetic gases.



Not adversely affected by anaesthetic agents\*

Does not kink

### Gas Sampling Lines Type H



Also have Luer Lock connections and additionally remove humidity. These sampling lines save costs by reducing or negating the need for regular exchange of water traps or absorbers.



Removes humidity

Does not kink

### VersaStream Sampling Lines

VersaStream sampling lines offer a fully disposable one-piece sampling solution for short-term ( $\leq 24$  hours) or long-term ( $\leq 72$  hours) use. This offers greater flexibility for the end-user.

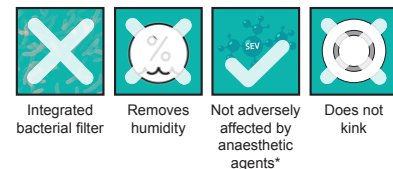

Integrated bacterial filter

Removes humidity

Not adversely affected by anaesthetic agents\*

Does not kink

These sampling lines are available with a range of different connectors: Viamed (Masimo/Phase-In), Luer Lock (general purpose), Respirationics (Philips), Oridion (Covidien). They are also available in multiple configurations of patient type, length and versions. VersaStream sampling lines remove moisture and incorporate bacterial filters, thereby both reducing costs and minimizing risk of cross-infection.

# capnography

## VersaStream® CO<sub>2</sub> Sampling Lines

Compatible for use with:

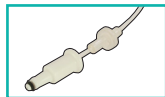

**Viamed VM-2500 series**  
Masimo, Phase-In



**Respironics**  
Philips, Dräger



**Luer Lock Male**



**Oridion**  
Nellcor, Covidien, Medtronics

### Available CO<sub>2</sub> sampling lines



**Nasal Sampling Line**



**Nasal Cannula**  
Available in Adult, Paediatric and Infant sizes and also available with O<sub>2</sub> delivery



**Nasal/Oral Cannula**  
Available in Adult and Paediatric sizes and also available with O<sub>2</sub> delivery



**Airway Adapter Sampling Line**  
Available in Adult/ Paediatric and Infant/ Neonatal sizes.  
Also available as separate sampling lines and a range of airway adapters.

# pulse oximetry



Viamed manufactures a range of hand held and finger pulse oximeters; as well as a series of reusable and disposable SpO<sub>2</sub> sensors, compatible for use with most OEM pulse oximeters and patient monitors.

## VM-2160 SMARTsat Pulse Oximeter

SMARTsat High performance SpO<sub>2</sub> technology enables accurate and reliable monitoring of all patients, from neonates to paediatrics to adults



## Finger Pulse Oximeters



A wide range of Finger Oximeters available for use with adults and paediatric patients



## SMARTsat SpO<sub>2</sub> Sensors

Reusable and disposable pulse oximetry sensors and cables for use with Viamed pulse oximeters and monitors

- Manufactured using the latest technology and materials
- Quality and robust designs
- Reliable and accurate

### The range includes:

- Finger sensors (with flaps)
- Soft silicone finger sensors
- Wrap sensors
- Ear sensors
- Disposable sensors
- Bio-compatible and latex free to help prevent allergic reactions
- Durable and reliable quality designs
- Now incorporating SMARTsat SpO<sub>2</sub> technology



## SMARTsat®

High performance SpO<sub>2</sub> technology for OEMs

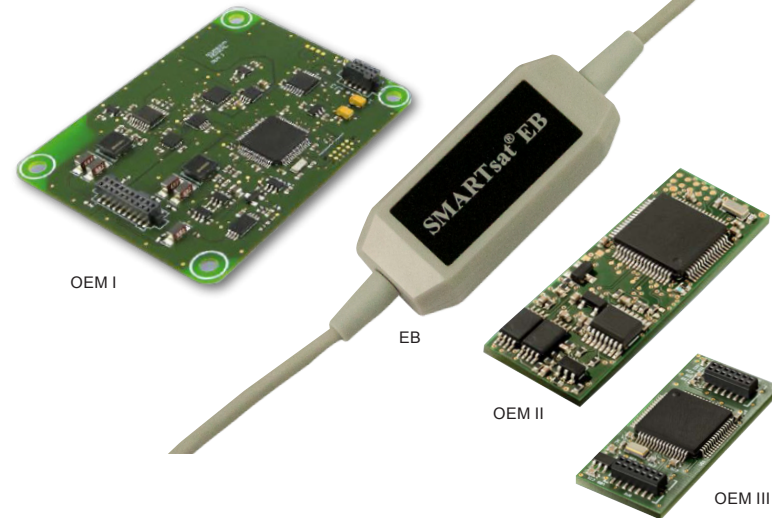

The very latest and innovative signal processing technologies and algorithms enable precise measurements, even under very difficult physiological conditions. SMARTsat technology has extremely low power consumption requirements, and is a real alternative for OEM customers who require high-end pulse oximetry solutions for their applications. This technology is now incorporated into the VM-2160 SMARTsat.





## Air/Oxygen Blender

Offers a simple, reliable and accurate method of delivering mixed gas to the patient



In order to offer maximum flexibility, blenders can be specified for either mounting on a pole or rail, with or without gas hoses, with a variety of flow meters.

Other blenders are available upon request offering different configurations and flow rates.

Blenders can be used to supply mixed gas to infant resuscitators, such as the Tom Thumb infant resuscitation unit.



## Maxtec Blender Series

The low-flow and high-flow **MaxBlend 2** with a built-in monitor allows you to measure oxygen percentage in a clean and dry environment, away from the patient - helping to eliminate cross-contamination.

The **MaxBlend Lite** is designed to provide all of the features of the MaxBlend 2 to customers already using a stand-alone blender.

The **Blender Buddy 2** equips your blender with the Maxtec DFB dual-scale flow meter and built-in oxygen, allowing gas to be analysed safely and away from the patient to avoid cross-contamination.



MaxBlend Lite



MaxBlend 2



BlenderBuddy 2

patient warming

phototherapy

## Ceratherm 600-3 Radiant Warmers

For maintaining the body temperature of infants, children and adults

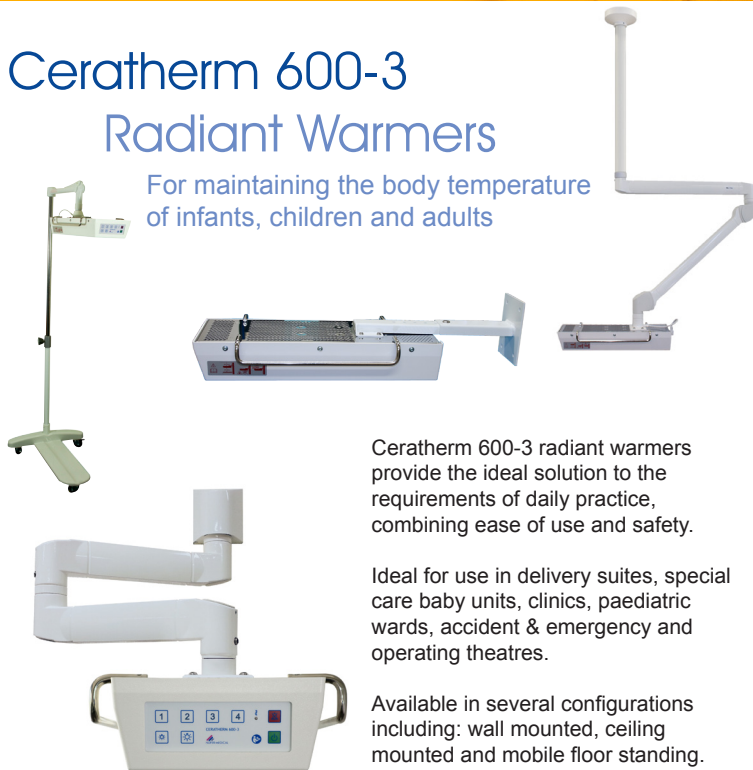

Ceratherm 600-3 radiant warmers provide the ideal solution to the requirements of daily practice, combining ease of use and safety.

Ideal for use in delivery suites, special care baby units, clinics, paediatric wards, accident & emergency and operating theatres.

Available in several configurations including: wall mounted, ceiling mounted and mobile floor standing.

## Phototherapy Eye Masks

The soft, safe and secure solution for eye protection during neonatal phototherapy

Viamed offers a range of phototherapy eye masks designed to assure optimum comfort and eye protection for neonates during phototherapy treatment.

### EyeMax2™ Phototherapy Eye Masks



**NeoMask**  
Phototherapy Eye Mask







The Posey range available from Viamed...

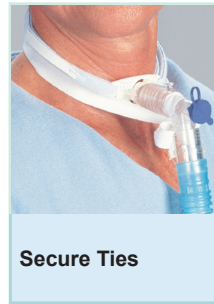
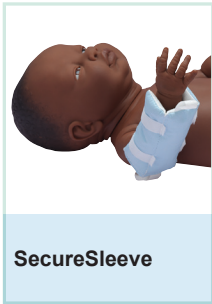

## V1000 Foetal Heart Simulator

Handheld device that has been designed for use by engineers, midwives and clinicians



To be used with foetal heart monitors and transducers for:

- Testing prior to use
- Fault finding and diagnosis
- Soak testing
- Simulation and training
- Use as part of a PPM procedure
- Verification of correct chart paper installed

## temperature probes



## breathalyser



### 400-AC Autoclavable Temperature Probes

For accurate monitoring of body surface and core temperatures



6.35 mm (1/4")  
Jack (mono)



6.35 mm (1/4")  
Jack (mono)  
Right angled



Hewlett Packard  
Philips



Siemens  
Dräger

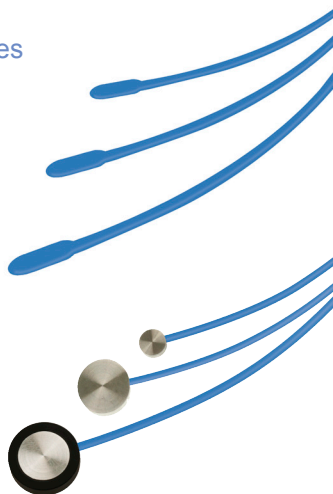

A complete range of autoclavable temperature probes for accurate measurement of body surface and core temperatures in neonatal, paediatric and adult patients.

### AlcoTrue® M Breathalyser

Professional medical breathalyser for rapid accurate determination of breath alcohol concentration

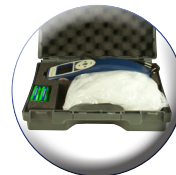

#### Ideal for use by

- Emergency Services
- Accident and Emergency Departments
- Rehabilitation Clinics

Other breathalysers available



# VIAMED



Part Number: 9990994

v 21.1

**Viamed Limited** · 15 Station Road · Cross Hills  
Keighley · West Yorkshire · BD20 7DT · United Kingdom  
Tel: +44 (0)1535 634 542 Fax: +44 (0)1535 635 582  
Email: [info@viamed.co.uk](mailto:info@viamed.co.uk) Website: [www.viamed.co.uk](http://www.viamed.co.uk)