

SUGGESTED FIRST AID:

SKIN CONTACT: NO HARMFUL EFFECTS - WASH WITH SOAP AND WATER AS REQUIRED.

EYE CONTACT: SHARP PARTICLES CAN CAUSE PHYSICAL IRRITATION: FLUSH WITH CLEAN WATER. SEEK MEDICAL ADVICE IF NECESSARY.

INHALATION: NO TOXIC EFFECTS.

INGESTION: NO TOXIC EFFECTS

HEALTH HAZARD DATA:

ALUMINIUM OXIDE/BAUXILITE CONTAINS NO FREE SILICA AND IS CLASSIFIED AS A NUISANCE MATERIAL.

ABRASIVE EXPOSURE LIMITS:-

SHORT TERM (10 MINUTES)	20mg/m <sup>3</sup>
LONG TERM (8 HOURS)	10mg/m <sup>3</sup>

IF EXCEEDED - REMOVE TO FRESH AIR

THE INFORMATION CONTAINED ABOVE IS AS SUPPLIED TO US BY  
THE MANUFACTURER

GUYSON FORMULA DIVISION

JUNE 1991

1148ECHK

**GUYSON INTERNATIONAL LIMITED**

P.O. BOX 18 OTLEY  
WEST YORKSHIRE

LS21 1RD

TELEPHONE: (0756) 799911

TELEX: 517700 GUYSON G

FAX: (0756) 790213

LODFIELD E.C. MOBILE ETCHING KIT - INSTRUCTIONS FOR USE

PLEASE READ ALL INSTRUCTIONS CAREFULLY BEFORE USE

LOADING THE STENCILS.

(A) Select the Stencils required for the registration number. Unscrew the locknut and remove it and the clamp plate from the end of the Stencil Holder. Starting with a Blank Stencil, slide the stencils into the machined groove on the front of the Stencil Holder. Make sure the individual Stencils interlock and overlap each other with no daylight showing between them. "Fill up" the machined groove with Blank Stencils to the end and replace clamp plate and locknut finger tight to hold all the Stencils in position. See diagram below:-

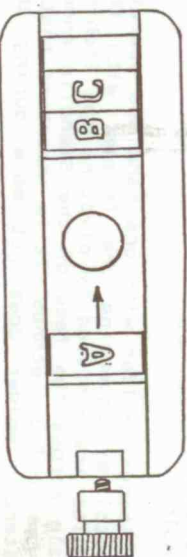

N.B. STENCILS MUST OVERLAP WITHOUT GAPS, OTHERWISE  
UNWANTED MARKS WILL APPEAR.

(B) Check the Registration number LOADED in the Stencil Holder against the ACTUAL Car Registration by viewing through the hole at the back of the Stencil Holder.

THIS IS EXTREMELY IMPORTANT AS WRONG NUMBERS CANNOT BE  
ERASED.

(C) Fit the rectangular Front Gasket to the front of the Stencil Holder by pressing it over the edges of the face of the Stencil Holder.

# MAINTENANCE INSTRUCTIONS

(A) The Etching Pistol Nozzle and Injector are prone to high rates of wear due to the continual flow of Abrasive during operation. For the sake of cost effective maintenance these components are removable and, although Case Carbursed to a high degree of hardness, the Nozzle will need replacing after marking approximately 200 to 300 cars. Failure to replace these parts will lead to poor performance and a higher than normal usage of Abrasive. In extreme cases irreparable damage to the Etching Pistol Casting can result.

(B) The Stencil Holder Dust Reclaim Bag will eventually become saturated with Abrasive Dust and should be replaced (or at least washed) after every 200 to 300 cars. Failure to clean or change the Dust Reclaim Bag regularly will lead to dust emission problems and hazards which come under the scope of COSHH.\*

(C) The Stencils are made from a soft nylon specially selected for its long-lasting properties, provided they are kept clean and undamaged.

(D) The Abrasive supplied is of the correct type and mesh size for use with the Lodfield Etching Equipment supplied. The Abrasive must be kept dry and free from any contamination from larger particles which may lodge in or damage the Stencils. The use of Lodfield Abrasive media is strongly recommended.

(E) We provide a full Abrasive and spare parts service for all consumables. Price lists are available on request.

For further details call: (0756) 799911

HAVING READ ALL THE INSTRUCTIONS CAREFULLY, YOU SHOULD NOW BE READY TO ETCH.

WE SUGGEST YOU PRACTICE ON A PIECE OF SCRAP GLASS FIRST. IF YOU HAVE ANY PROBLEMS WITH THE INSTRUCTIONS OR THE EQUIPMENT, PLEASE DO NOT HESITATE TO CONTACT US IMMEDIATELY.

\* CONTROL OF SUBSTANCES HAZARDOUS TO HEALTH REGULATIONS.

Abrasive caught in the Dust Filter Bag, which also allows excess compressed air to escape to atmosphere without creating a dust hazard, can be emptied out and re-used by loading it back into the Pistol Canister.

(G) After completing the sequence of marks for a vehicle, disconnect the Etching Pistol from the Air-Coil, connect the Blow-Off Gun and use this to thoroughly disperse any residual Abrasive dust left on the car.

(H) Unload the Stencils from the Stencil Holder by reversing the instructions in paragraph (A). The Stencils should then be returned to their respective slot(s) in the Compartment Box.

## POSSIBLE PROBLEMS AND REMEDIES.

If any of the above instructions are not carried out precisely as written, snags may occur, examples of which follow:-

(A) Incomplete Mark/Certain Digits Missing:

Cause: Nozzle has not travelled evenly along full length of Stencils.

Remedy: Ensuring that the Stencils are lined-up perfectly with the clearly marked digits, blast again.

(B) Frosty, Fuzzy Mark:

Cause: Stencils not touching glass during blasting.

Remedy: Always ensure the Front Cassette is tight against the glass before and during blasting.

(C) Double Image:

Cause: Left hand moving during blasting.

Remedy: Always apply firm pressure and do not move left hand.

(D) End Digits Not Visible:

Cause: Nozzle wear.

Remedy: Check Nozzle and Injector at regular intervals and replace when worn.

SPARE PARTS

1	E.C. PISTOL HANDLE	700003
2	E.C. PISTOL T-PIECE	300061
3	E.C. PISTOL CANISTER	300062
4	E.C. PISTOL BRASS REDUCER	300063
5	E.C. INJECTOR WITH O-RINGS	300068
6	E.C. ETCHING NOZZLE - 6" Case Hardened	100016
7	E.C. NOZZLE STOP	300072
8	E.C. STENCIL HOLDER	300089
9	E.C. FRONT GASKET	300093
10	E.C. BACK GASKET	300094
11	E.C. DUST RECLAIM BAG	300116
12	E.C. JUBILEE CLIP	300117
13	E.C. MALE Q/R COUPLING 1/4" MALE BSP	100036

NOT ILLUSTRATED

E.C. STENCIL - NYLON:-	300095
1 x A - Z, 1 x 0 - 9	300096
4 x A - Z, 4 x 0 - 9	
E.C. COMPARTMENT BOX	300097
E.C. BLOW-OFF GUN WITH Q/R COUPLING	900014
E.C. RECOIL AIR-LINE	300115
E.C. WINDOW STICKERS:-	
Non-Alarm (25)	300124
Alarm (25)	300125
Personalised (1000)	300126
E.C. 40 SECOND POSTER	300129
E.C. ABRASIVE - ALUMINIUM OXIDE 80/120:-	
10 Kg	805013
25 Kg	805015
E.C. FEMALE Q/R COUPLING WITH 1/4" HOSETAIL	100033

\*\*\*\*\*  
E.C. ETCHING PISTOL 900032  
E.C. MOBILE ETCHING KIT 900044  
\*\*\*\*\*

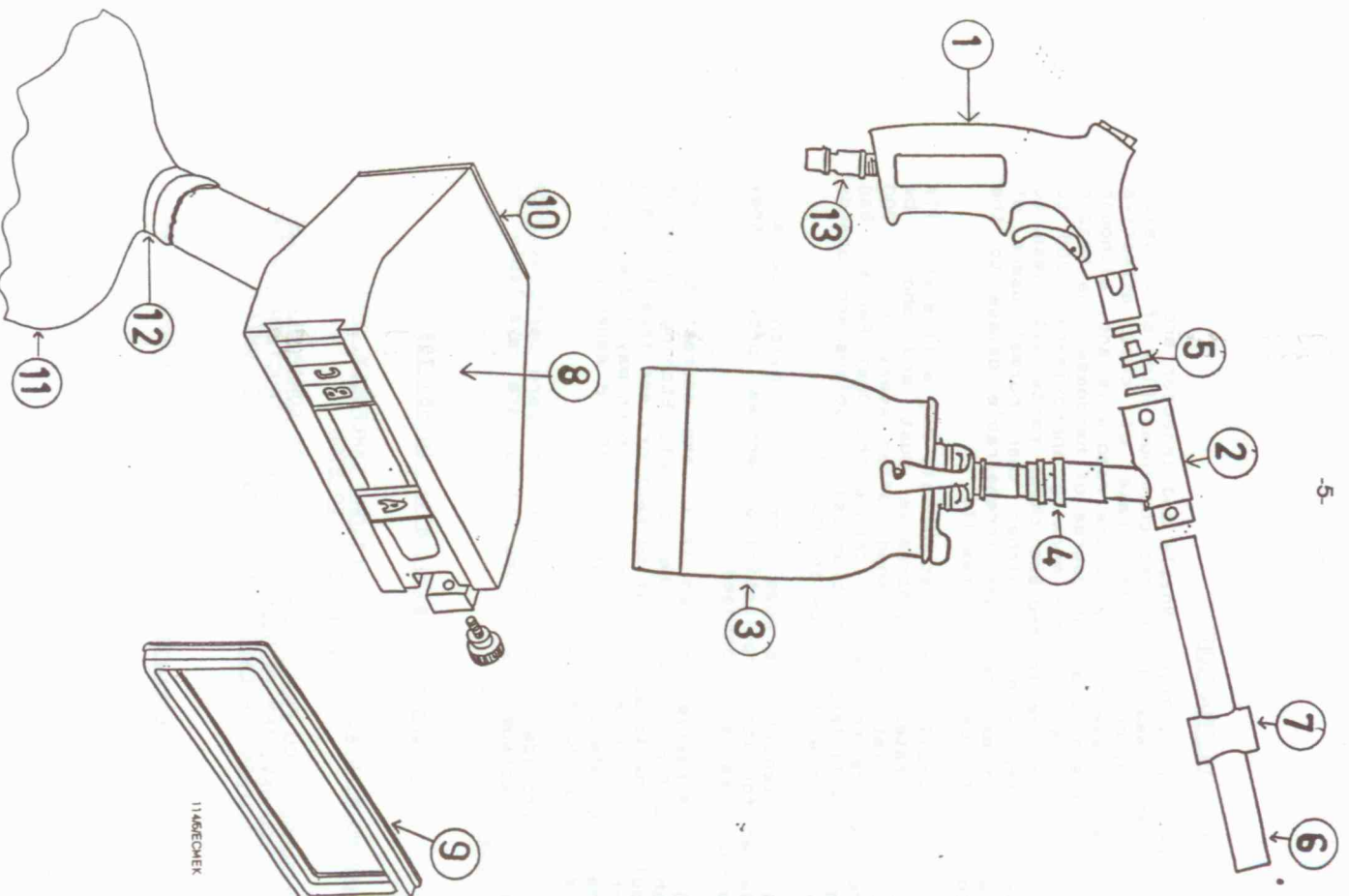



# OPERATING THE SYSTEM

(A) Remove the Etching Pistol Canister by releasing the clamp. Fill the Canister with Dry Abrasive of the correct grade to approximately two-thirds capacity. Ensuring that there is no abrasive on any of the mating surfaces, replace the Canister.

(B) Connect the Etching Pistol to a DRY Airline giving a constant air supply of 4.5 c.f.m. at a pressure of 80-90 p.s.i.

(C) Place the pre-loaded Stencil Holder unit in position on the vehicle window, ensuring that sufficient space has been left for the positioning of any Window Sticker which may be applied later.

(D) Pick up the Etching Pistol and insert the end of the Nozzle into the rear of the Stencil Holder. Push in until the round Nozzle Stop is resting firmly against the rear of the Stencil Holder.

(E) Steady the Stencil Holder with one hand and operate the Etching Pistol by squeezing the Trigger with the other. Best results are achieved by pivoting the Etching Pistol and Nozzle across the face of the Stencils once, taking about three to four seconds. It is important that:

- (i) the Stencil Holder does not move during the Blast Sequence, and
- (ii) the Stencils are flat on the glass.

The above requirements are best achieved by pressing the Stencil Holder against the window using the combined pressure from the Etching Pistol Nozzle Stop and your steady hand. This will compress the soft rubber Front Gasket around the Stencil Holder, allowing the Stencils to touch the glass whilst retaining an air-tight seal.

CURVED GLASS:- Blast a vertical mark on curved glass to ensure that the equipment is on a straight level surface.

(F) After blasting release the Trigger, thereby shutting off the air supply. There will be some residual Abrasive inside the Stencil Holder, and to prevent this spilling all over the vehicle, it is essential to remove the Stencil Holder from the glass with care. First lower the Etching Pistol handle and tilt back the Stencil Holder. This will allow any Abrasive inside to fall back and down into the Dust Filter Bag. Then pull the Stencil holder straight back from the glass.

11/10/76/10/1

## SAFETY DATA SHEET

### MATERIAL:

ALUMINIUM OXIDE ABRASIVE

*SART Grain*

BROWN/WHITE BAUXILITE ABRASIVE

### DESCRIPTION:

ABRASIVE AND REFRACTORY SYNTHETIC AGGREGATE

### INGREDIENT:

Al <sub>2</sub> O <sub>3</sub>	90-100%
TiO <sub>2</sub>	0-5%
SiO <sub>2</sub>	0-4%
Na <sub>2</sub> O	0-1%

### PHYSICAL DATA:

MELTING POINT	2050°C (Al <sub>2</sub> O <sub>3</sub> )
BOILING POINT	OVER 3000°C
SPECIFIC GRAVITY	3.95
SOLUBILITY	INSOLUBLE IN WATER
FLASH POINT	N/A
COLOUR	BROWN-GREY-WHITE
ODOUR	NONE
SHELF-LIFE	INDEFINITE

### FIRE AND EXPLOSION DATA:

NON-HAZARDOUS

### REACTIVITY DATA:

NON-HAZARDOUS - STABLE

### ENVIRONMENTAL INFORMATION:

NON-HAZARDOUS

### PRECAUTIONARY INFORMATION:

USE EYE AND HAND PROTECTION AND FACE MASK WHEN USED UNDER PRESSURE.