

6.19

70-5000
(12-78)



MANUFACTURING CORPORATION

P.O. BOX 97, BENTON HARBOR, MICHIGAN 49022
PHONE 616-926-6171

**OPERATING AND
MAINTENANCE INSTRUCTIONS
AND
SERVICE KITS
FOR MODELS**

**DOA
DAA**

**OIL-LESS DIAPHRAGM
VACUUM PUMPS AND
AIR COMPRESSORS**

6.19

OPERATING and MAINTENANCE INSTRUCTIONS

Do not at any time lubricate any of the parts with oil, grease, or petroleum products nor clean with acids, caustics or chlorinated solvents. Be very careful to keep the diaphragm from contacting any petroleum product of hydro carbons. It can affect the service life of the pump.

DANGER: To prevent explosive hazard, Do NOT pump combustible liquids or vapors with these units.

To clean or replace the filters and/or rubber gasket, remove the five (5) phillips screws in the top of the unit. The filters and gasket are located beneath this top plate. Remove the filters and wash them in a solvent and/or blow off with air and replace. The gasket may be cleaned with water. Replace the filters in proper position and replace the gasket. Note that the gasket and top plate will fit in one position only.

To replace the diaphragm, remove the four socket cap screws from the head of the pump. The diaphragm is held in place by two phillips head screws. Remove screws, retainer plate, and the diaphragm. The diaphragm will fit in any position on the connecting rod. Replace the plate and the two phillips head screws. Torque to 30 inch-pounds.

Caution: Do not raise any burrs or nicks on the heads of these screws. These burrs could cause damage to the inlet valve.

For replacing the inlet and outlet valve, remove the slotted machine screw that holds each valve in place. The stainless steel inlet and outlet valves are interchangeable. Clean them with water. When replacing the outlet valve, place the new valve in location and note there is a retaining bar near the machine screw hole. This retaining bar holds the valve in position. When replacing the inlet valve, note that the valve holder is marked with an X in one corner. This X should be in the lower right hand corner toward the inlet of the air chamber. Replace the head and tighten the socket head screws to 90-100 inch-pounds of torque.

Do not attempt to replace the connecting rod or motor bearings. If after cleaning the unit and/or installing a new Service Kit, the unit still does not operate properly, contact your representative, the factory, or return the pump to one of our authorized Service Centers.

WIRING INFORMATION

For any D.C. unit — red lead goes to positive side of power source.

For any permanent split capacitor motor which has four (4) leads is as follows:

Brown leads to capacitor.
Black leads to Power Source.

For any permanent split capacitor motor which has (3) leads is as follows:

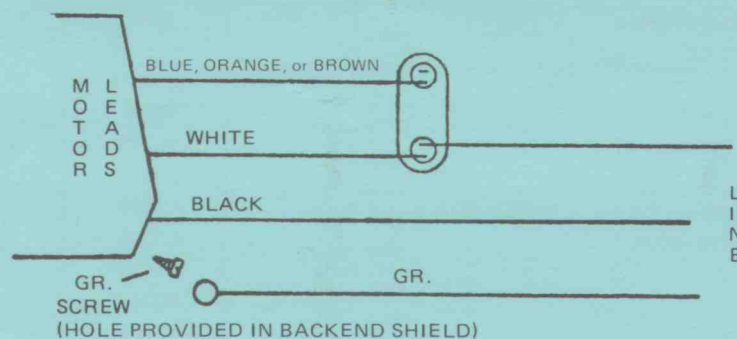

DO NOT AT ANY TIME ATTEMPT TO REMOVE THE CONNECTING ROD OR COMPLETELY DISASSEMBLE THE PUMP. IF IT DOES NOT GIVE YOU THE PROPER SERVICE EVEN AFTER INSTALLING A NEW SERVICE KIT, PLEASE RETURN IT TO ONE OF THE AUTHORIZED SERVICE CENTERS WHICH ARE LOCATED AT:

Brenner-Fiedler and Associates
16210 Gundry Avenue
Paramount, CA 90723
213/636-3206

Gast Manufacturing Corporation
515 Washington Avenue
Carlstadt, NJ 07072
201/933-8484

Gast Manufacturing Corporation
2550 Meadowbrook Rd.
Benton Harbor, MI 49022
616/926-6171

Wainbee, Ltd.
121 City View Drive
Toronto, Ontario
Canada
416/248-5621

Wainbee, Ltd.
215 Brunswick Blvd.
Pointe Claire, Montreal
Quebec
Canada
514/697-8810

REF. NO.	DESCRIPTION	PART NO.	Model DOA	DAA *
1	COVER	AF808	1	2
• 2	HEAD GASKET	AF820	1	2
• 3	FILTER/MUFFLER ELEMENT	AF998A	2	4
• 4	FILTER ELEMENT	AF857A	1	2
5	HEAD	AF804	1	2
• 6	VALVE SCREW	BB309	2	4
• 7	VALVE RETAINER	AF856	1	2
• 8	LEAF VALVE	AF817	2	4
9	VALVE RETAINER	AF819	1	2
10	RETAINER PLATE	AF809	1	2
11	DIAPHRAGM	AF818A	1	2
12	FELT SPACER	AA929	2	4
12A	SPACER	AG970	1	2
13	FAN	AF533	1	1
**13A	FAN	AF533A		1
14	GRILLE	AF807	1	2
15	RIVET	AE946	4	8
16	TANK	AC189	1	1
17	ADAPTOR PLATE	AE969	2	
17	ADAPTOR PLATE	AF980		2
18	DRAIN VALVE	AE248	1	1
19	CHECK VALVE	AE761A	1	1
20	PRESSURE GAUGE	AA806	1	1
21	GLOBE VALVE	AE251	1	1
22	PRESSURE SWITCH	AF265	1	1
23	PLASTIC TUBE	AD159N		1
23	PLASTIC TUBE	AD159G	1	
24	ELBOW	AE216B	1	1
25	TEE	BA418	1	2
26	PLASTIC TUBE	AD159M		1
27	TUBE CONNECTORS	AF838		2
28	TUBE CONNECTORS	AG427	1	1
29	PLASTIC TUBE	AE814C	1	1
30	ELBOW	AE261A	1	1
31	FAN ASSEMBLY	AG371	1	1
32	CENTRIFUGAL SWITCH	AG373	1	1
33	SPRING	AG376	1	1
33	SPRING (USED ON EXTRA PUNCH DOA ONLY)	AG377	1	
34	GRILLE ASSEMBLY	AG366	1	1
35	O-RING	AF938	1	1
36	POPPET	AG367	1	1
37	SPRING	AG369	1	1
38	PUSH-ON	AG370	1	1

• Indicates parts included in SERVICE KIT.

Use SERVICE KIT K294A for the DOA diaphragm units. Order (2) K294A SERVICE KITS for DAA units.

Use KIT K294 for units with Serial Number of 1278 or before.

*Double ended pump – shown mounted on tank.

**Opposite rotation for opposite end of DAA units.

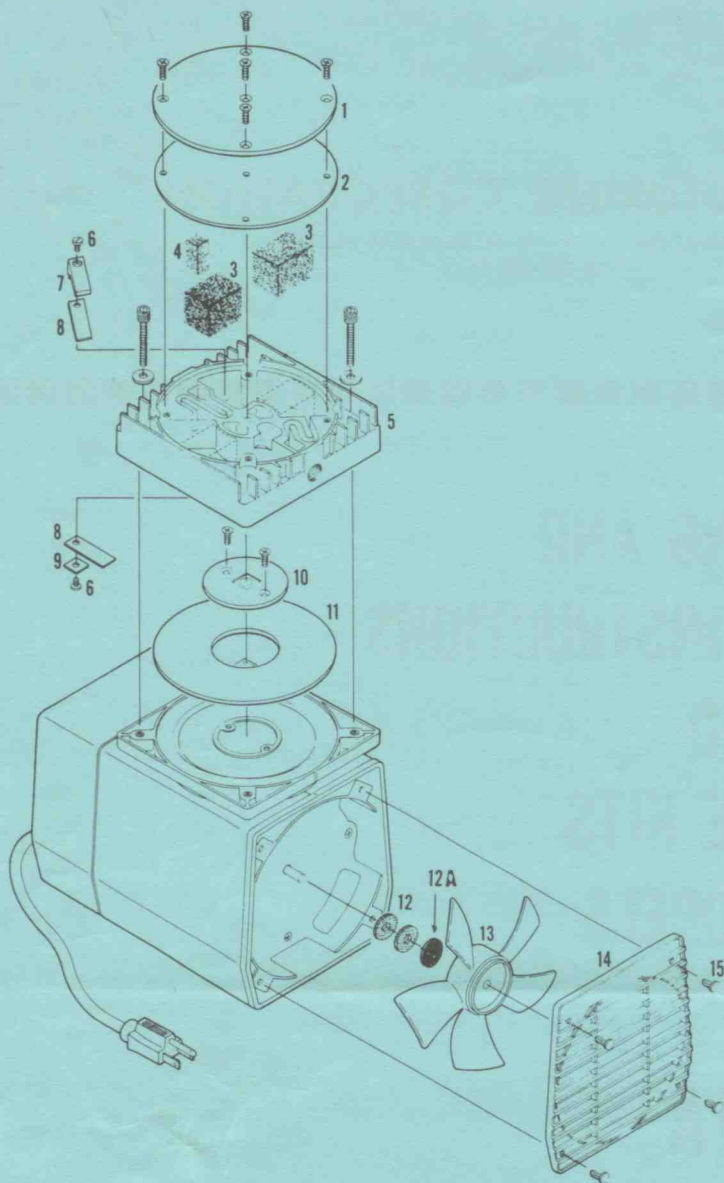

UNLOADER ASSEMBLY

This assembly can only be installed by an authorized service center. The only item which may be replaced in the field is the grille assembly (item 34) which includes items 35-38.

