

Oxygen Sensor Model	AII-11-60
---------------------	-----------

Measuring Range	0-100% O <sub>2</sub>
Signal Output (1)	3.5-5.5mV
Response Time 90%	6 seconds
Accuracy Full Scale (2) (3)	± 1%
Accuracy Over Operating Range (4)	± 5%
Drift % Signal/Month (2)	< 1%
Linearity (2) (3)	± 1 %
Recommended Flow Rate	0.1-10 lpm
Temperature Coefficient	Compensated
Operating Range	0 to 45° C
Packaging	Polyethylene bag in 3"x3"x1.5" paper box
Humidity Non-Condensing	0-99% RH
Expected Life (1)	60 months
Storage Temperature (5)	0 to 45° C
Warranty (6)	18 months

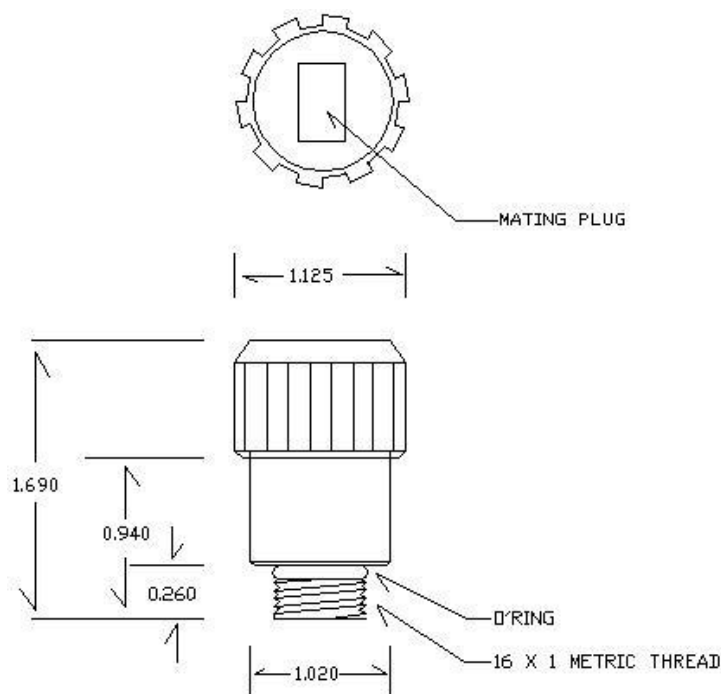

Electrical Connections	RJ-45 Phone jack
Mechanical Connections	16mm x 1mm thread with 15mm flow

Specifications validated during design and in the pursuit of improvement are subject along with prices to change without notice.

1. In air (20.9% oxygen) at 25° C and 1 atm.

2. At constant temperature, pressure and humidity. when calibrated at 100%.

3. For optimum performance at elevated oxygen levels > 40%, calibrate with 100% oxygen.

4. From the signal output value established above, and, once the sensor reaches equilibrium (approximately 1 hour) following step change of 15°C or more.

5. Sensors may be stored up to 55°C on an intermittent (up to one week) basis only, such as during transportation. Refer to (1) relative to the Expected Life.

6. Ex-Factory unless otherwise agreed to in writing. Under normal operating conditions for medical oxygen delivery equipment the sensors are warranted to be free of defects in materials and workmanship for the specified period above provided the sensor is properly installed and operated. The sole remedy for a sensors determined to be defective by Analytical Industries Inc. is limited to replacing the defective sensors. Analytical Industries Inc. shall not be liable for buyer's negligence, misapplication alteration, abuse or accident.

