

Information contained on this drawing is confidential and may also contain proprietary **bluepoint MEDICAL GmbH&Co.KG**/customer information. Drawing content is only intended for use of the above customer. If you are not the intended recipient or authorized employee of above company name, you are hereby notified any use, duplication, reconstruction, or distribution of drawing information is strictly prohibited.

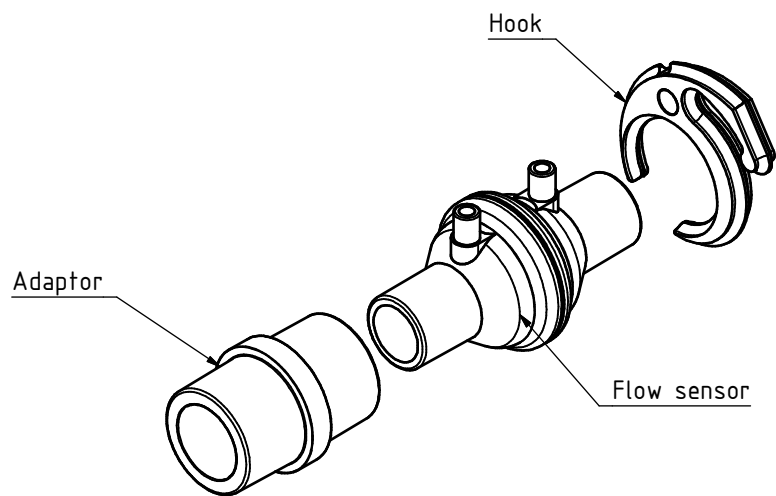

### SpiroTrue H - OEM disposable single patient adult flow sensor

#### Sensor technical data:

- Measuring principle: differential pressure measurement
- Reproducibility:  $\leq 10\%$  at flow range 0 to 100 L/min
- Designed in accordance with 93/42/EEC (Annex I and Annex II)
- Housing material: ABS - Sensor weight:  $\leq 9,5\text{g}$
- Dead space:  $\leq 10\text{mL}$
- Connections: 15M/15M - ISO 5356-1
- Conforms to EN ISO 10993-5
- Non-sterile packaged

#### Recommended storage conditions:

- Temperature:  $-20^{\circ}\text{C}$  to  $50^{\circ}\text{C}$
- Humidity ( r.H. ) : 5% to 95%
- Storage period:  $\leq 3$  years (unopened, away from direct sunlight)

#### Recommended operating conditions:

- Temperature:  $10^{\circ}\text{C}$  to  $40^{\circ}\text{C}$
- Relative humidity: 5 to 95%, non-condensing

#### Notes:

- Before using of the sensor, consult the appropriate ventilator user instructions for more detailed information
- SpiroTrue H is compatible with Hamilton single use flow sensor PN: 279331

#### Order codes:

**REF 1030132000** - Box of 6pcs: SpiroTrue H with 2m double PVC (DEHP FREE) tube, incl. hook and adaptor

**REF 4030131003** - SpiroTrue H with 2m double PVC (DEHP FREE) tube

**SpiroTrue H- typically flow charachteristics**

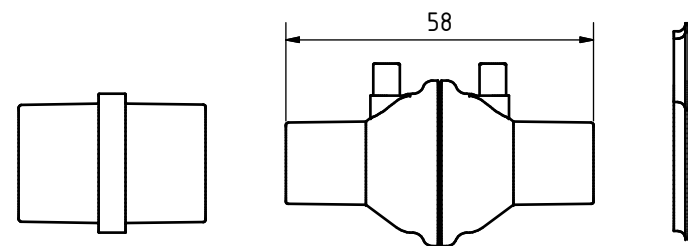
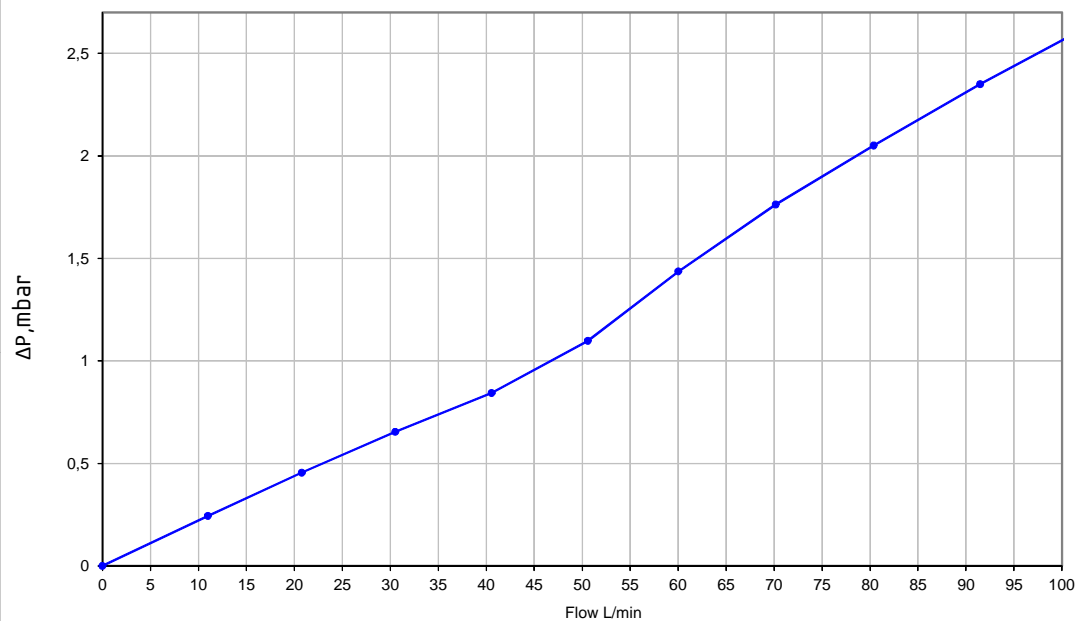

bluepoint MEDICAL							
				Date	Name	SpiroTrue H-Technical data	
				Drawn by: 12.07.2013	N.Radev		
				Checked by: 15.07.2013	B.Lindner		
				Approved by: 15.07.2013	B.Lindner	Rev6-17022017	
Status	Changes	Date	Name			1	
						A3	